

Bridge 114.3 Replacement

Project Description

The Alaska Railroad Corporation (ARRC) will replace an aging 123-foot Pratt style pony truss bridge and two 35-foot I-beam spans crossing Ship Creek in lower downtown Anchorage at ARRC milepost 114.3. The project will replace the aging bridge with a new ballast deck bridge consisting of two 79-foot and one 30-foot steel I-beam spans.

Purpose

The pony truss bridge is nearing the end of its useful life. Replacement will help railroad infrastructure remain in a state of good repair. The integrity of bridge infrastructure ensures the safety and reliability of rail operations to meet business demands. General bridge rehabilitation benefits are outlined in the current Bridge Program fact sheet.

Benefits

A new, stronger crossing structure will:

- Decrease maintenance costs, with significantly less upkeep needed for many years.
- Reduce the likelihood of a bridge failure and associated service interruption.

Status

- Environmental review required by the National Environmental Policy Act (NEPA) was completed in October 2024.
- Final design is complete and construction bid is expected to be awarded by April 30, 2025. Steel fabrication contract for the superstructure has been awarded to Jesse Co. in Seattle WA.
- Construction is expected to be completed in Summer 2026.

Cost and Funding

The budget for the project's construction phase is \$15.4 million, with 80% funded through a Federal Transit Administration grant, 20% is funded by ARRC

More Information

For more information, email the Alaska Railroad at Public_Comment@akrr.com. The ARRC Bridge Program fact sheet is available online at [AlaskaRailroad.com](https://www.alaskarailroad.com) > Corporate > Projects (look under *Systemwide Projects*).



Bridge 114.3 crosses Ship Creek in an industrial area of lower downtown.

Project Area - Bridge MP 114.3 Side View

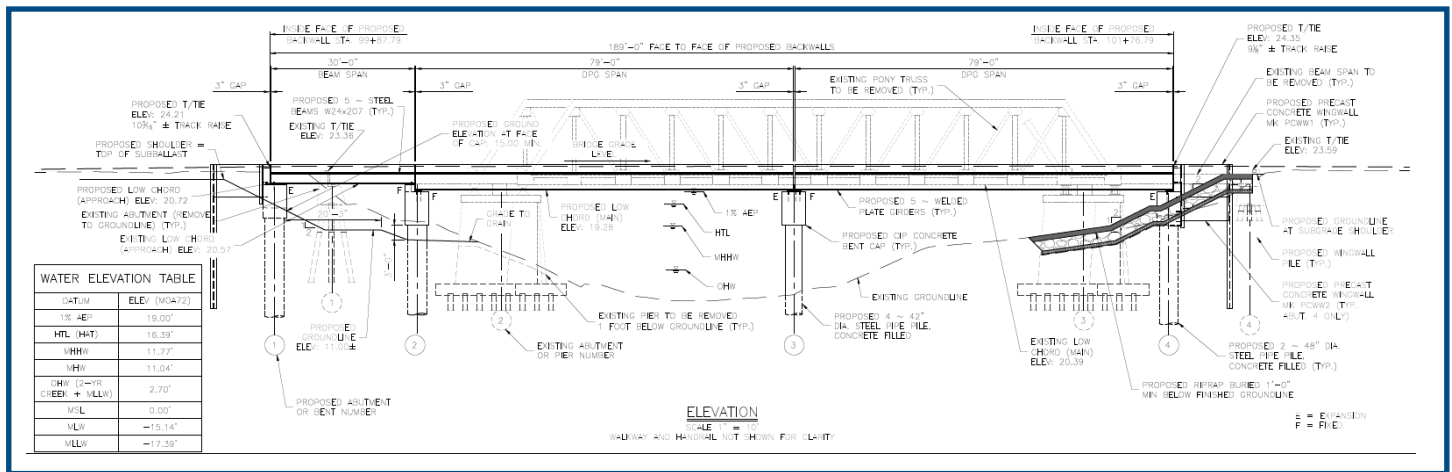

Project Area - Bridge MP 114.3, Top View

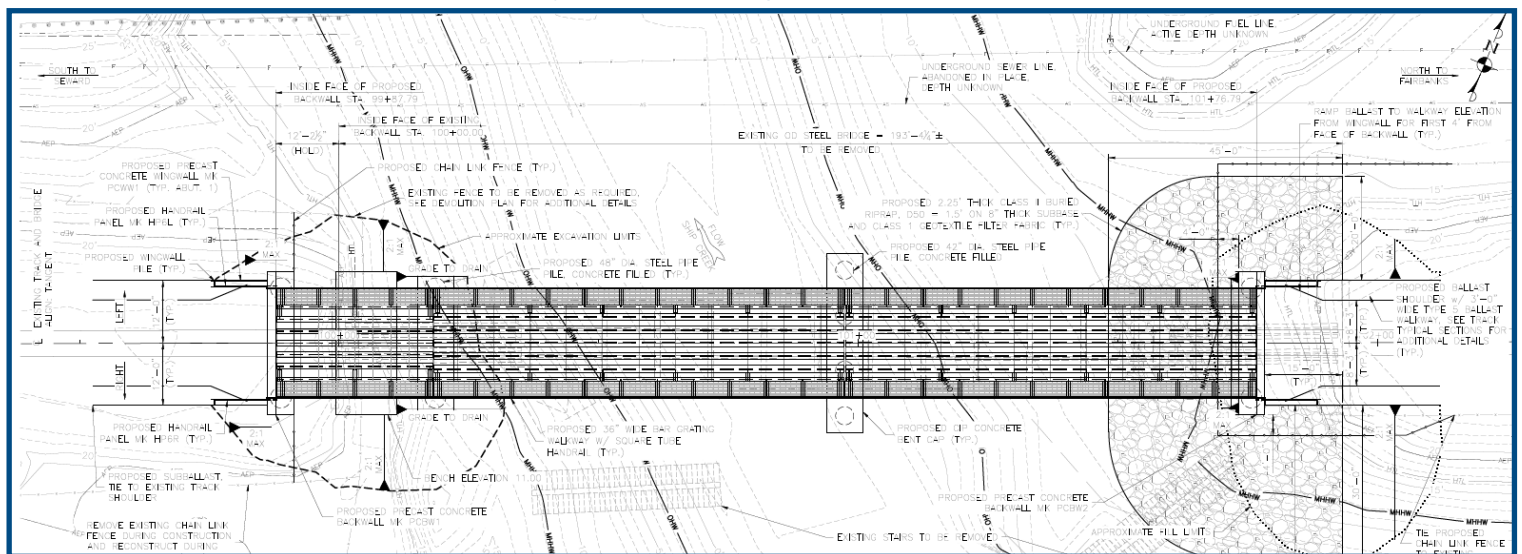

**Bridge at
Milepost 114.3.**